

6

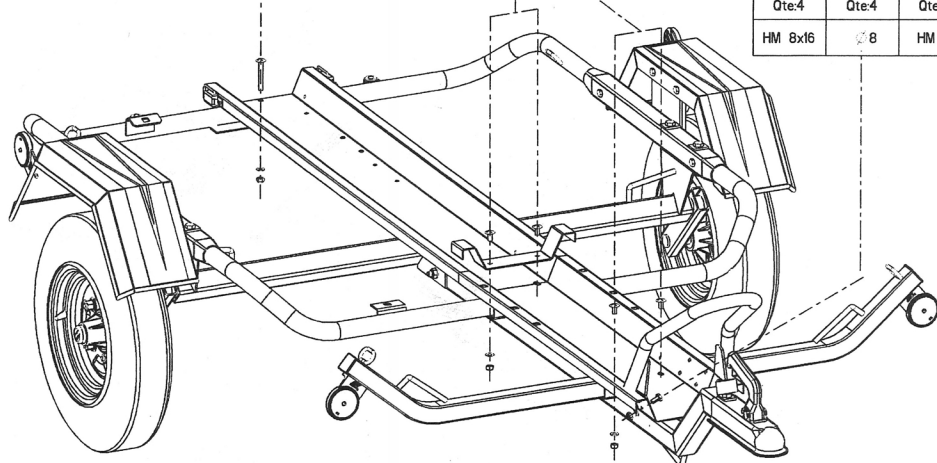

7

**TIGHTEN THE REAR PART
OF THE RAIL AFTER
LOCKING OF THE 2 LOCKS**

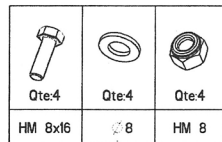
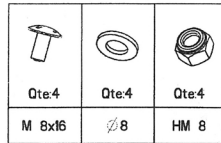
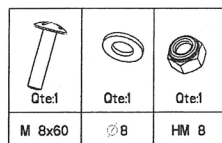
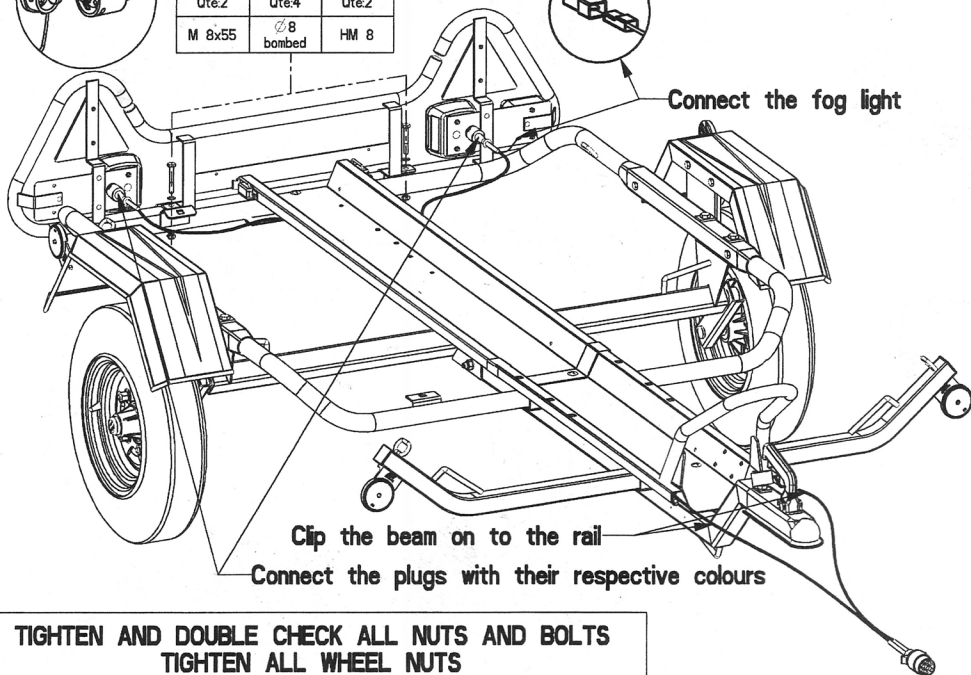
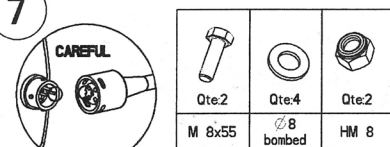

58401704-A

ERDÉ
you move, so do we!

MANUFACTURER'S WARRANTY

This trailer is designed to fit B.S.I. / T.U.V approved towing hitches. The manufacturer's warranty is limited to the repair or replacement of merchandise which proves defective in materials and/or workmanship, for a period up to one year (6 months for moving parts) after the purchase date (as shown in sales receipt), provided that the instructions are correctly followed and the product is properly used. If any article is found to be defective, the purchaser should return it with proof of purchase (sales receipt is proof of purchase and guarantee starting date), to the place of purchase. Repair or replacement is at the discretion of the manufacturer and no unauthorized returns will be accepted. If the trailer is found to be defective upon discretion, the manufacturer will repair or replace the trailer at its discretion, without charge. Freight is not included. This does not affect your statutory rights.

ASSEMBLY AND USAGE INSTRUCTIONS

MOTOR-BIKE TRAILERS ERDÉ - MODELS

▪ PM 310/1R

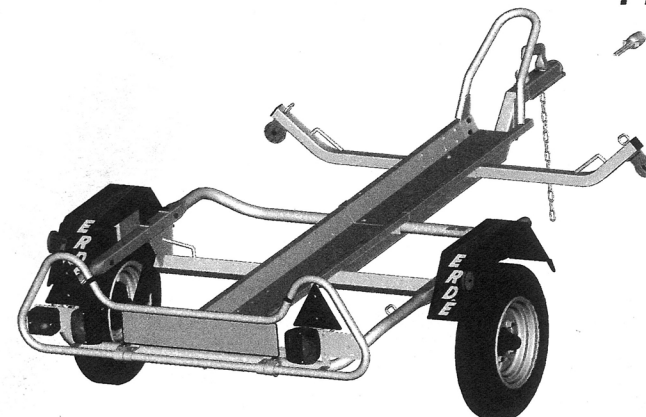

Equipments available as option

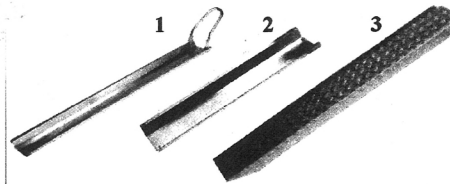
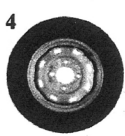
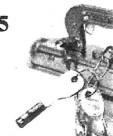
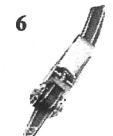
EQUIPMENTS		PM310/1R			
1. Rail with front wheel holders 2mtrs long.		De série			
2. Small loading ramp 1mtr long.		RC001			
3. Reinforced loading ramp 1,5mtr long.		RC450			
4. Spare wheel.		RS 400X10		5	6
5. Coupling lock.		AV001			
6. ratchet strap with hooks 4,50mtrs long.		09191038			

EQUIPMENT AS OPTION : SPARE WHEEL

CAREFUL : Additional nuts and bolts to be kept for fitting of some optional equipments.

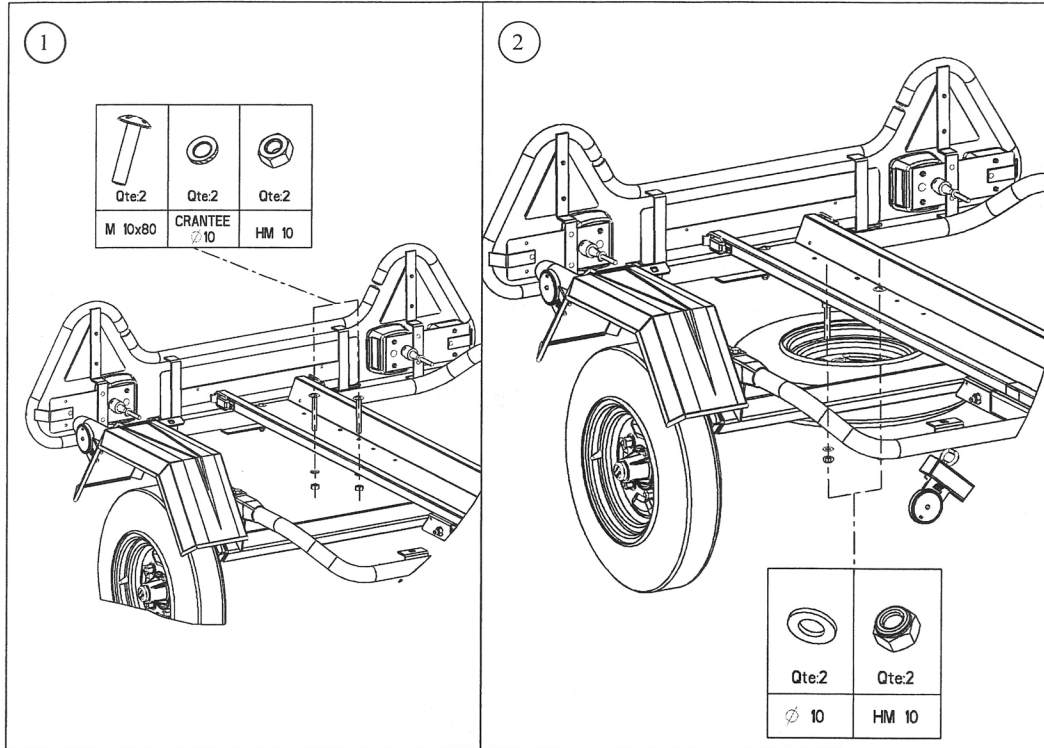

USE AND MAINTENANCE OF ERDE TRAILERS

USE AND MAINTENANCE OF ERDE TRAILERS PM310/1R

These trailers are light duty luggage road trailers and are not suitable for industrial use.

1) COUPLING

On the drawbar : all ERDE trailers are equipped with a 50 MM ball coupling with safety catch, which prevents the trailer becoming detached.

COUPLING AND UNCOUPLING OF TRAILER

Proceed as follows: lift the end of the handle attaching the coupling to the towball, operating at the same time the locking trigger on the handle.

Option It is possible to install an anti-theft device that locks the coupling and provides added security. This is a recommended optional extra.

On the car : towing brackets of a recognised standard should be fitted. Preferably these should comply with the relevant British and international standards (UL standards AU113 and 114 and international standards ISO1103 and 3553). European standard for towball is 50 MM diameter. (Tow bars 400 to 600 kgs sufficient for all ERDE trailers)

For additional security a safety chain is fitted as standard. This should be secured to the towing bracket at all times, so that in the event of uncoupling the trailer will still be attached to the towing vehicle. (UK Reg.1995)

2) MAINTENANCE

VERY IMPORTANT

Road trailers must be kept in a road-worthy condition and it is a legal requirement that all trailers be maintained and comply with the different regulations. While there is very little maintenance required on ERDE trailers, it is important that the unit should be checked annually. After assembly and the first 60 miles, check the tightness of all nuts/bolts of the following main parts :

* wheels * coupling head * mudguard * drawbar * lighting

3) HUBS

The wheel hubs including bearing are pregreased for life. No greasing needs to be done. When necessary, replacement hubs and bearing are available as spares. Do not put trailer in sea water, damage may occur if hubs/axle immersed in salt water.

4) LOADING

VERY IMPORTANT

For your own safety it is important that the trailer is not over loaded. The suspension units and tyres are designed to carry the following maximum weights.

MAXIMUM LOAD PERMISSABLE

- MODEL PM 310/1R - 240 Kilos

It is an offence to load the trailer to more than its marked gross weight.

The responsibility for loading the trailer must be that of the user and as a guide, the following table will give some typical loads :

QUANTITY/LOAD

4 suitcases
3 tents
6 rucksacks
70 logs

APPROXIMATE UNIT WEIGHT

25 Kilos
18 Kilos
40 Kilos
3 Kilos

TOTAL WEIGHT

100 Kilos
80 Kilos
240 Kilos
210 Kilos

To obtain good road holding, it is important that the load is loaded with sufficient weight on the drawbar (5% to 10% of the load). A load on the rear will cause pitching of the trailer. Once loaded, ensure that the trailer drawbar is always kept horizontal or slightly on its nose, towards the car. If this is not the case, change the height of your bracket by using a drop plate which will allow you to change the height of the coupling.

If fitting a drop plate, refer to drop plate instructions.

Spares can be obtained from **Wilstow Ltd 08707636125**

5) TYRE PRESSURE

Inflation pressure should be checked regularly to avoid any risk of abnormal wear and punctures. 350x8 wheel : 2.5 bar/36 LBS per SQ inch - 480x8 wheel : 2.5 bar/36 LBS per SQ inch 400x10 wheel : 3.5 bar/50 LBS per SQ inch - 500x10 wheel : 3.5 bar/50 LBS per SQ inch 135x13 wheel : 2.5 bar/36 LBS per SQ inch - 145x13 wheel : 2.5 bar/36 LBS per SQ inch If heavily loaded, or for long trips, it is necessary to increase tyre pressure by 0,50 bars.

Please note : all trailers wheels and tyres fitted to these trailers must be pneumatic and capable of taking the maximum gross unit weight. They must be rated to 60 MPH and maintained at the correct tyre pressures. As with motor vehicles, it is illegal to drive with a mix of radial and crossply tyres on the same axle. Option a spare wheel and fixing kit is available and is highly recommended for safety and convenience.

6) ELECTRICAL CONNECTIONS

The electrical fittings are based on the European standards system equivalent BS 149A.

- Contact Block N° 1 - Left indicator (Yellow or orange wire)
- Contact Block N° 2 - Fog lamp (Blue wire)
- Contact Block N° 3 - Earth (White wire)
- Contact Block N° 4 - Right indicator (Green or violet wire)
- Contact Block N° 5 - Right tail + N° plate lights (Brown wire)
- Contact Block N° 6 - Stop lights (Red wire)
- Contact Block N° 7 - Left tail + N° plate lights (Black wire)

7) REGISTRATION

The number plate of the trailer must be identical to the towing vehicle.

The size of the number plate should be as per BS standard 520 MM.

Hand written number plates are not acceptable and are illegal.

(Total gross weight of an unbraked trailer includes the weight of the trailer and the load). It is an offence to load the trailer to more than its marked gross weight.

1

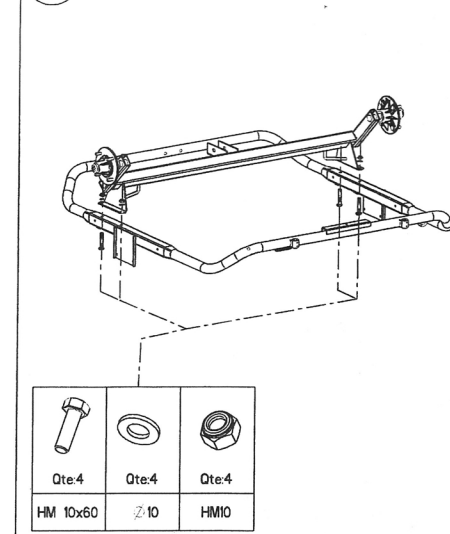

2

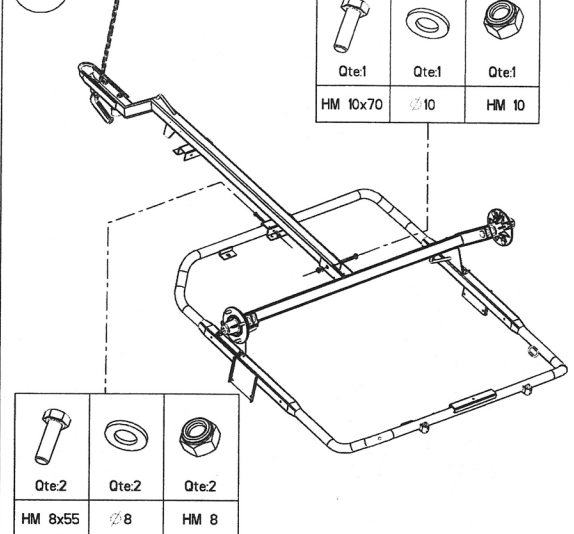

3

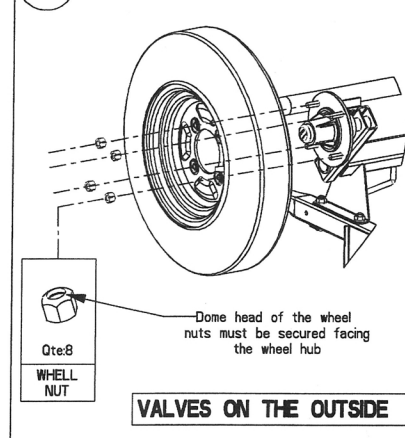

4

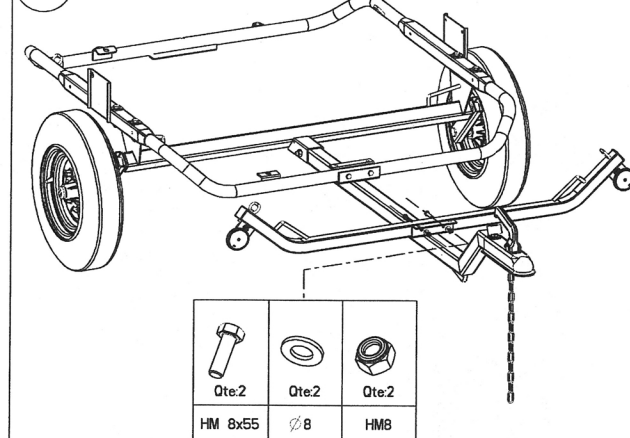

5

