

WARNING READ BEFORE INSTALLING AND OPERATING WINCH INSTALLATION

Mounting structure must be capable of withstanding loads within the capacity of the winch. Mount winches with 3/8" (M10) diameter bolts and lock nuts.

OPERATING

Ambient operating temperature between -10°C and +50°C. Do not exceed the load capacity rating of the winch. Capacity rating is based on one layer of line around drum. As line builds on drum, capacity decreases. Obtain cable and rope manufacturers recommendation for size and type. Use proper end connection for attaching the hook to the cable or rope. When anchoring line to drum, 4 to 6 wraps must remain on drum to supply friction for a proper anchor. Keep rope or cable properly aligned on drum.

CAUTION: NEVER FULLY EXTEND THE ROPE OR STRAP OR CABLE WHILE UNDER LOAD.

INSPECTION & MAINTENANCE

Moving parts including gears, ratchets and shafts must be kept clean and lubricated to insure proper and safe operation.

Components can be affected by chemicals, salts and rust and should be examined for safe operation before each use. Do not operate winch if line is knotted or kinked or has any sign of weakening. Please replace a new line to ensure the operational safety. Be sure that the steel cable, rope or strap is strong enough to move the load.

Keep hands away from load bearing cables, ropes, sheaves, drums and pulleys while operating. If the switch spring is broken or locking system failure, please stop operation and repair.

CAUTION

Boat trailers not equipped with keel and side hull rollers are designed to be submerged in the water when the boat is loaded, i.e., the boat should be "floated" onto the trailer. If the trailer is not submerged, attempts to "drag" the boat onto this type of trailer can cause winch failure and possible injury.

Winches are not designed to secure boats to trailers. Boat tie downs should be used.

Do not release handle when ratchet lever is in unlocked position with load on winch. Handle could spin violently which may cause serious injury.

WARNING

This winch should only be used for hauling or pulling loads. It must not be used for lifting or lowering loads or for the movement of humans.

NOTE :

For increased strength and safety, this winch should be mounted with three 3/8" (M10) bolts, washers and lock washers as shown in the drawing.

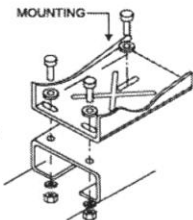

INSTRUCTIONS FOR ATTACHING STRAP TO WINCH DRUM

Position the looped end of the strap between the sides of the drum and between the two round holes next to the drum centre. Pass the M8 bolt provided through the first drum side, the strap loop and the second drum side. Fit and tighten the M8 nyloc nut so the thread protrudes beyond the nylon. Do not over-tighten. See photo.



INSTRUCTIONS FOR ATTACHING CABLE TO WINCH DRUM

Pass the steel cable through the angled hole in the drum side, from inside to outside. Wrap the cable once around the outer drum spindle and secure into the clamp provided, as shown, with nuts and shake-proof washers on the outside of the drum. Ensure nuts are fully tightened and there is 25mm cable beyond the clamp. **CAUTION :** Maintain at least four (4) complete wraps of cable on the drum to ensure it can't pull loose under load.



HANDLE AND NUT MUST BE
TIGHTENED AGAINST
SHOULDER BEFORE
OPERATING WINCH.

Only use the following approved accessories :

MP	Type	For MP	Dimensions	Fittings
1450	winch cable	1420/1425/1432	6mm diameter x 8m (26') length	forged hook & fixing kit
1455	winch strap	1420/1425/1432	63mm width x 8m (26') length	forged hook & fixing kit



Made in Taiwan on behalf of
Maypole Ltd, Birmingham, UK.
sales@maypole.ltd.uk
www.maypole.ltd.uk

MAYPOLE



MP1420

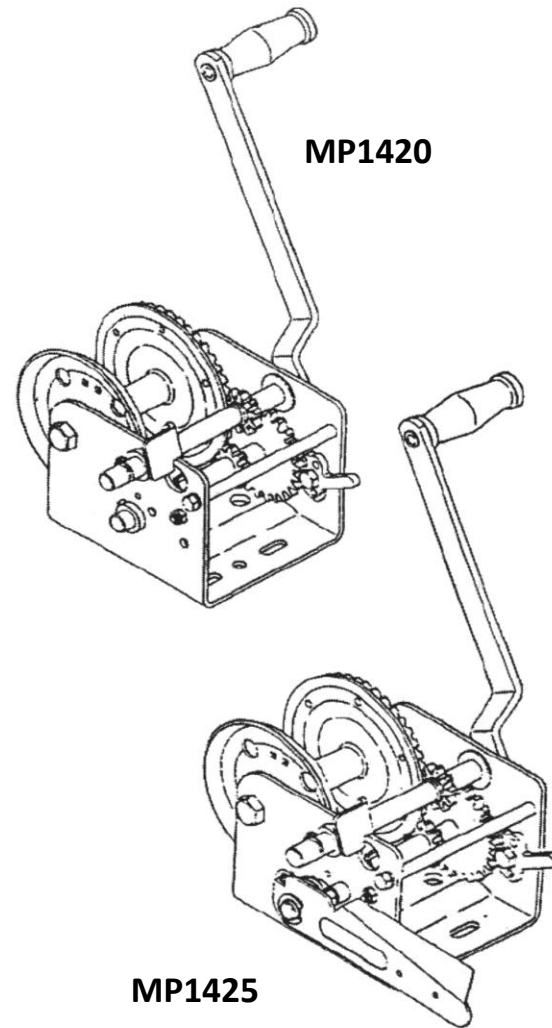

MP1425

Instructions

Read carefully before use

MP1420

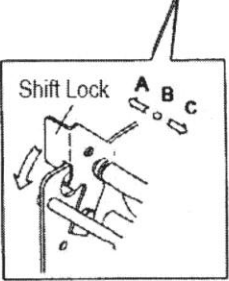
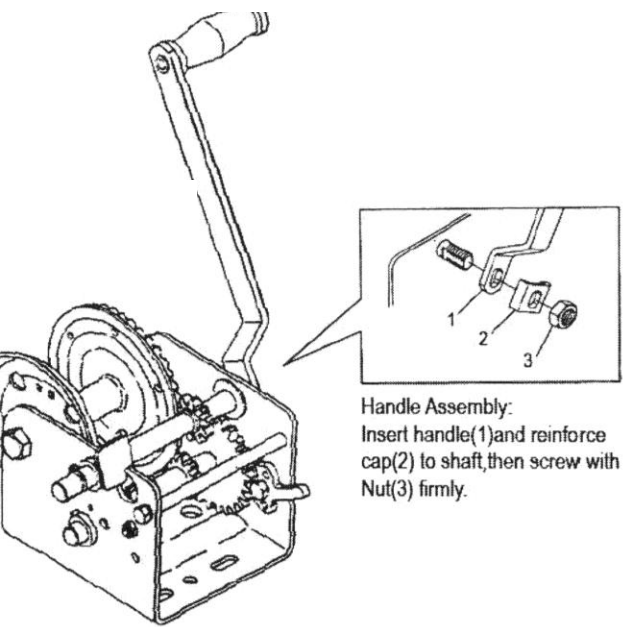

Convertible speed system

IMPORTANT:
To avoid injury from spinning handle.
1.Ratchets must be engaged when cranking load in or changing gears.
2.Shift lock must be engaged in neutral position when pulling cable off drum.

WARNING: High forces may be created by use of a winch creating potential safety hazards; therefore, it is recommended that you don't allow anyone who is not familiar with these operating instruction to operate the winch. **THIS WINCH IS NOT DESIGNED TO BE A HUMAN HOIST AND SHOULD NEVER BE OPERATED WHEN THERE IS PERSONS ON OR UNDER THE LOAD BEING MOVED.**

MP1425

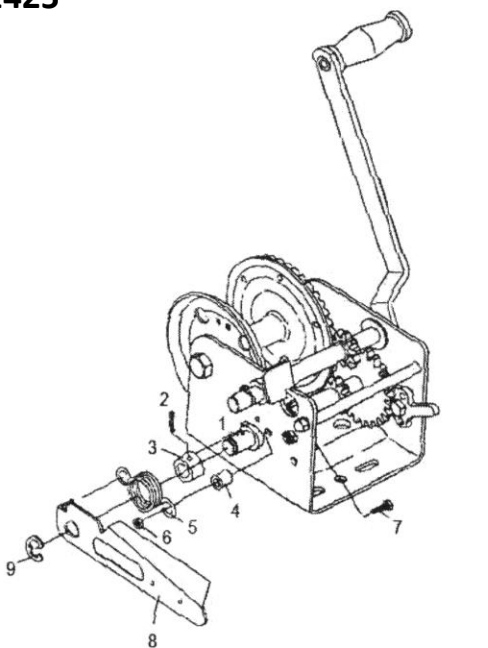

Please see left side for Handle Assembly and the instruction of Shift Lock.
Please see right side for Hand Brake Installation.

Hand Brake Installation

- A.Insert brake drum (3) to pinion shaft (1) and knock pin into symmetrical holes on brake drum & pinion shaft. (Please refer to Fig. 1)
- B.Insert pivot bolt (7) thru frame side and then thru the spacer (4) Slide brake spring (5) over brake drum (3), and brake spring loop on to pivot bolt (7) and secure with lock nut (6). (Please refer to Fig. 2)
- C.Assembly the brake handle (8) on to pinion shaft (1), making sure the tab on the brake handle is inserted into the other end loop of the brake spring (5) press retaining ring (9) into groove to secure the brake handle on to the pinion shaft. (Please refer to Fig.3)

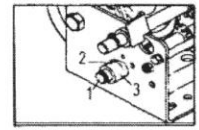

Fig.1

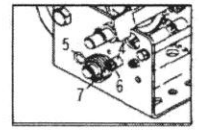

Fig.2

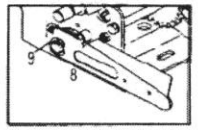

Fig.3

- IMPORTANT:**
- Check installation for correct operation before putting a load on the winch. The brake drum must normally be free to rotate when the winch ratchet is in either position. If the brake is dragging, you will not be able to pull line off of the drum. The brake spring must tighten around the brake drum. When pressure is applied downward on the handle.
 - Periodically check the brake components for proper operation and replace if necessary.
 - The brake spring should be free of grease and oil an not damaged.

Winch Specifications										
MP	CE Rated Working Capacity	Manufacturer's Recommended Max. Capacity	Speeds	Gear Ratio	Min / Max Mechanical Advantage	Operating Force Required	Drive Gear	Brake Supplied	Finish	
1420	500kg	900kg / 2000LB	2	4.3:1 / 11.2:1	73:1 / 190:1	6.84kg / 2.63kg	single	yes	500 hour	
1425	625kg	1100kg / 2500LB	2	5.5:1 / 14.3:1	93:1 / 242:1	6.72kg / 2.58kg	single	yes	500 hour	