

ACCESSORIES & SPARES

4 x T Bolts are provided for fitting additional accessories. Please check with the accessory manufacturer they are suitable before fitment.

RBS1090	Spare Feet (Pair)
RBS1091	Spare End Caps (Pair)
RBS1092	Spare Allen Key
RBS1093	Spare T-Bolts (Pair)

Manufactured on behalf of Maypole Ltd Birmingham

The UK's Leading Towing & Touring Company

Website: www.maypole.ltd.uk

Email: sales@maypoleltd.co.uk

FITTING INSTRUCTIONS

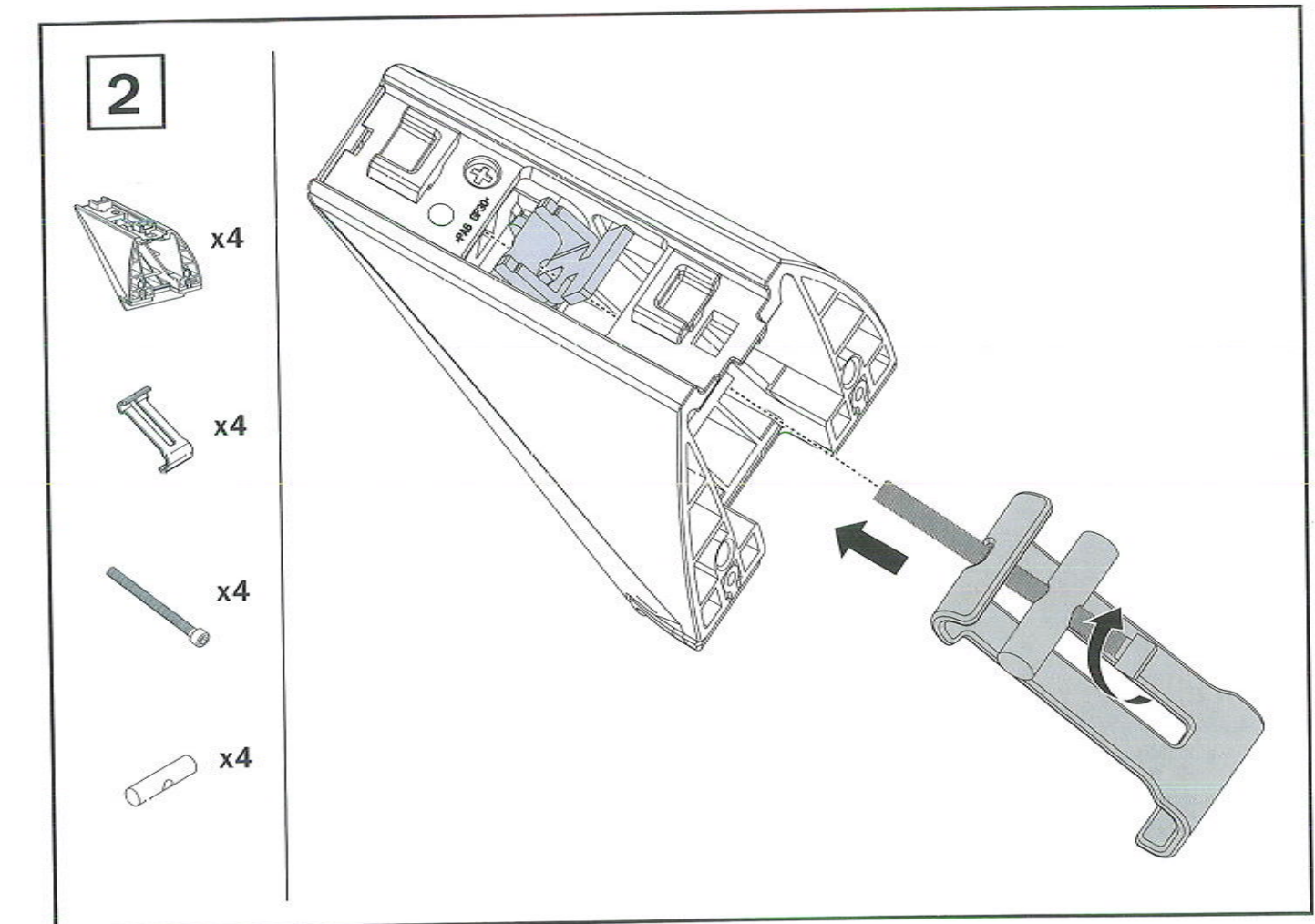
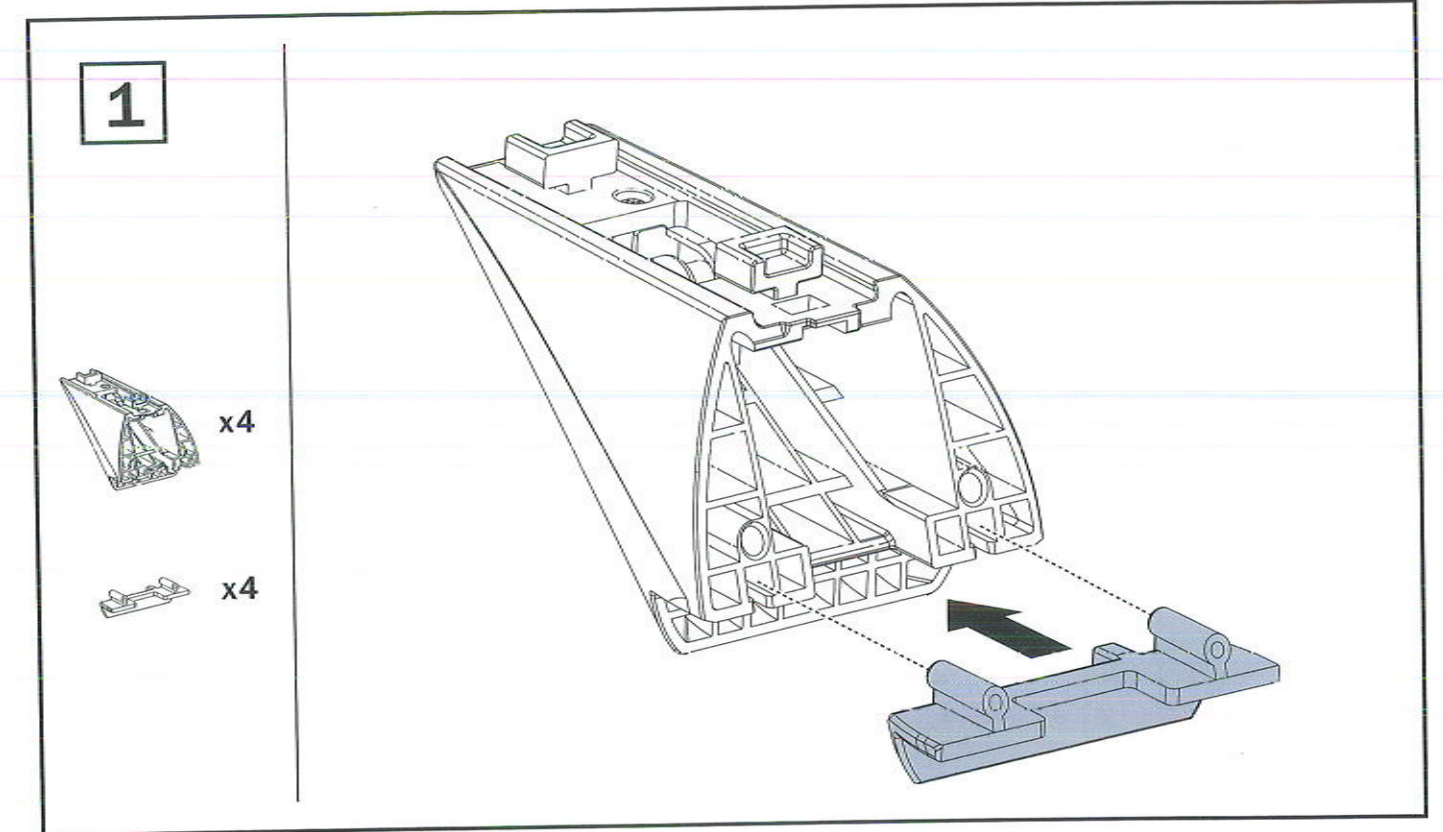

CONTENTS

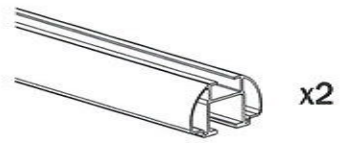

x2



x4

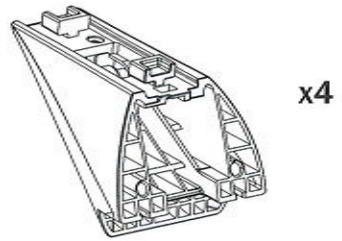

x4

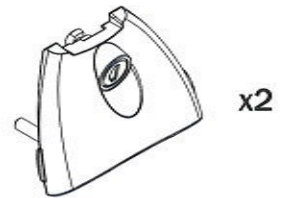

x2

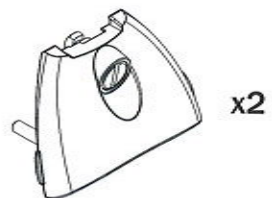

x2

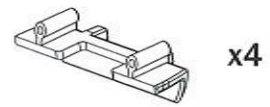

x4



x4



x4



x4

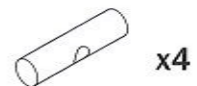

x4



x1

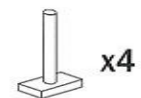

x4

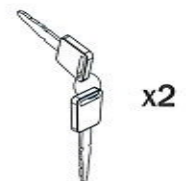

x2



Instructions for Roof Bars RB1090 (1.2m Aluminium Bars For Profile Rails) & RB1095 (1.35m Aluminium Bars For Profile Rails)

BEFORE PURCHASE

- ☒ Ensure these roof bars are suitable for your vehicle's roof rails. Size Guide (all dimensions are approximate):
 - RB1090: overall length 1.2m (Excluding End Caps), max. rail separation 98cm
 - RB1095: overall length 1.35m (Excluding End Caps), max. rail separation 113cm
- ☒ **IMPORTANT** – these roof bars are only suitable for flush mounted vehicle roof rails due to the profile of their cross section as shown in the image below. If in doubt, consult your vehicle's manufacturer or local dealer:



WARNING – GENERAL SAFETY

The attachment of these roof bars to a vehicle is safety critical and beyond the control of the manufacturer. The user must therefore ensure that the roof bars are suitable for use with their particular vehicle and that the roof bars are securely and safely attached to the vehicle without causing damage.

1. Check the Aluminium roof bars are held securely by the jaws and that the jaws are securely clamped to the vehicle's roof rails before every trip.
2. Every time before use, check the roof bars for security of fittings or any sign of wear and tear. Replace any worn or damaged parts. **Do NOT** drive with the roof bars fitted if any part is worn or damaged, or if the roof bars have not been fully secured to the vehicle's roof rails.
3. During your journey, frequently check the security of the roof bars and the load carried.
4. **Do NOT** exceed the maximum carrying capacity, whichever is the lower of the vehicle roof rails (see handbook) or the 90kg maximum carrying capacity of the roof bars.
5. Drive carefully, be aware of cross winds, avoid sudden braking or hard cornering and reduce speed accordingly when using the roof bars.
6. Avoid any protrusions beyond the side of the car as these may present a risk of injury to passers-by.
7. Do not overload. Distribute loads evenly on the roof bars.
8. Large loads generate a great deal of drag, even if they are lightweight. The resultant forces on the roof bars greatly increase with speed – the load could become detached or the vehicle roof damaged if speed is not limited appropriately and the load well secured.